

Safety Zones:
Longways-15m
Sideways-0.5m



DIVERSION ROUTE
A44 -
A40 -
A415 -
A4095 -

ACCESS TO BE
MAINTAINED BY GATEMEN
WHEN SAFE TO DO SO.

DIVERSION ROUTE USES
DUAL CARRIAGEWAY.

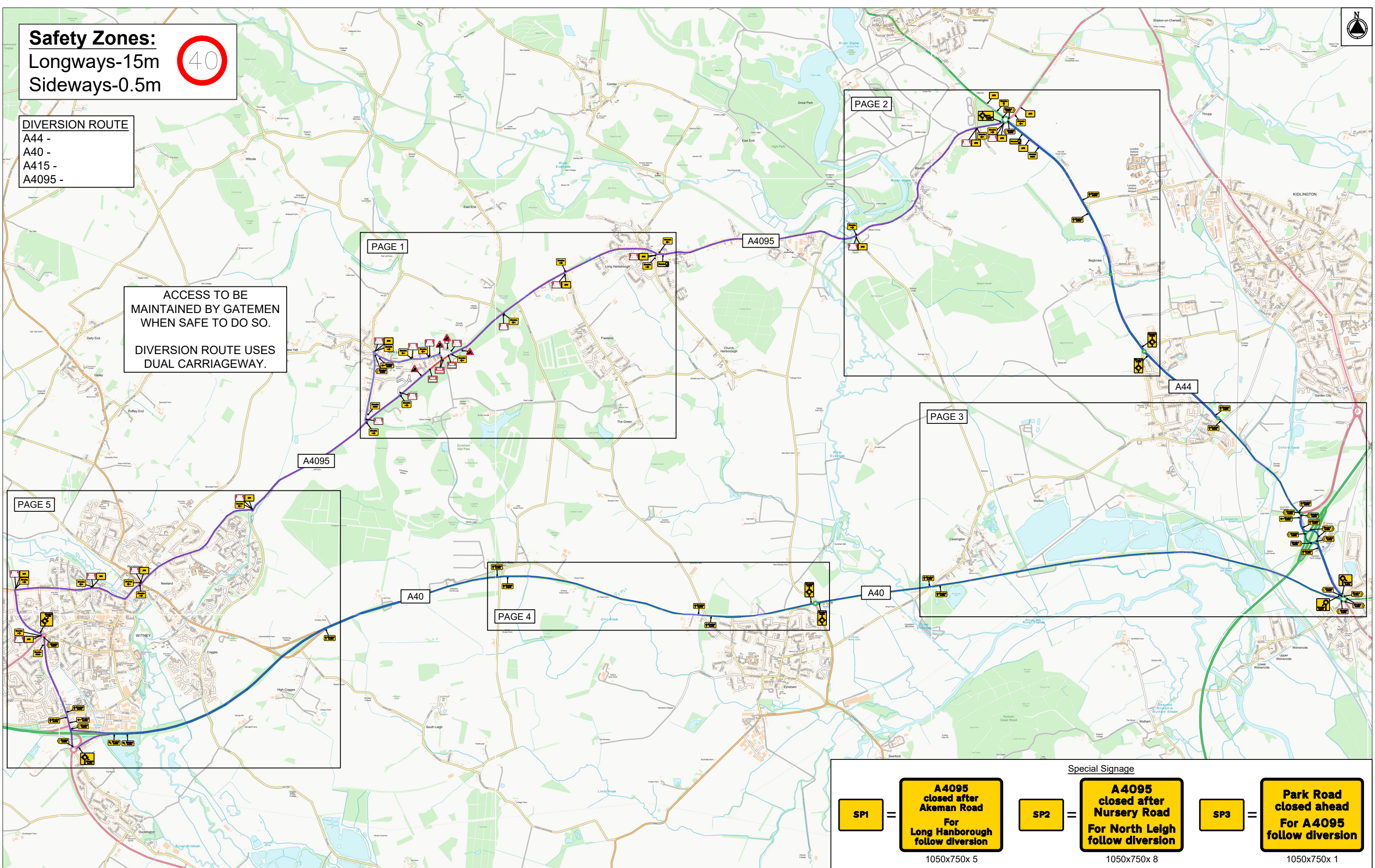

Special Signage

SP1 =

**A4095
closed after
Akeman Road
For
Long Hanborough
follow diversion**
1050x750x 5

SP2 =

**A4095
closed after
Nursery Road
For North Leigh
follow diversion**
1050x750x 8

SP3 =

**Park Road
closed ahead
For A4095
follow diversion**
1050x750x 1

	Client	Project Name CARRIAGEWAY WORKS	Site Address A4095 NORTH LEIGH OX29 6SL	Key Sign Closure Point Diversion Route <div><div></div><div></div><div></div></div>	<div>OVERVIEW</div>	<table><tr><td>Scale</td><td>Size</td><td>Surveyed</td><td>Date Drawn</td><td>Drawn</td><td>Client Checked</td><td>Client Approved</td></tr><tr><td>NTS</td><td>A3</td><td></td><td>30.08.2023</td><td></td><td>AR</td><td>AR</td></tr><tr><td colspan="2">Drawing Status</td><td colspan="2">Draft For Discussion</td><td colspan="2">For Issue</td><td>As Built</td></tr><tr><td>Rev No.</td><td>Rev Date</td><td colspan="2">Purpose Of Revision</td><td>Drawn</td><td>Checked</td><td>Approved</td></tr><tr><td>1</td><td></td><td colspan="2"></td><td></td><td></td><td></td></tr><tr><td>2</td><td></td><td colspan="2"></td><td></td><td></td><td></td></tr><tr><td colspan="5">Drawing No. TMCD7167/OVERVIEW</td><td colspan="2">Rev No.</td></tr></table>	Scale	Size	Surveyed	Date Drawn	Drawn	Client Checked	Client Approved	NTS	A3		30.08.2023		AR	AR	Drawing Status		Draft For Discussion		For Issue		As Built	Rev No.	Rev Date	Purpose Of Revision		Drawn	Checked	Approved	1							2							Drawing No. TMCD7167/OVERVIEW					Rev No.	
						Scale	Size	Surveyed	Date Drawn	Drawn	Client Checked	Client Approved																																											
						NTS	A3		30.08.2023		AR	AR																																											
						Drawing Status		Draft For Discussion		For Issue		As Built																																											
						Rev No.	Rev Date	Purpose Of Revision		Drawn	Checked	Approved																																											
						1																																																	
						2																																																	
Drawing No. TMCD7167/OVERVIEW					Rev No.																																																		
<div>Notes</div> <div>1. All dimensions are in meters unless otherwise stated.</div> <div>2. All TM to comply with Chapter 8 of the Traffic Signs Manual.</div> <div>3. All road markings and signs to be comply to TSRGD 2016.</div> <div>4. All minimum safety zones to be met at all times.</div> <div>5. <u>TM drawings to be checked for suitability by foreman/ supervisor/ TSCO before installation. If no negative comments or refusal is received before installation, it is deemed that the design is suitable.</u></div> <div>6. Contains Ordnance Survey data. Crown copyright and database 2019</div>																																																							